







01

Who we are

We are a technology Portuguese company operating in the market since 2016, focused on the development of access control solutions.

Our goal is to provide advanced access control solutions to our clients, whether businesses or individuals, allowing them to increase the profitability of their ventures, automate recurring activities, and add comfort and security to their daily lives.

Currently, our solutions are present in 14 European countries, as well as in Mozambique and Brazil. We already have approximately 4000 customers and have performed over 6 million door openings.

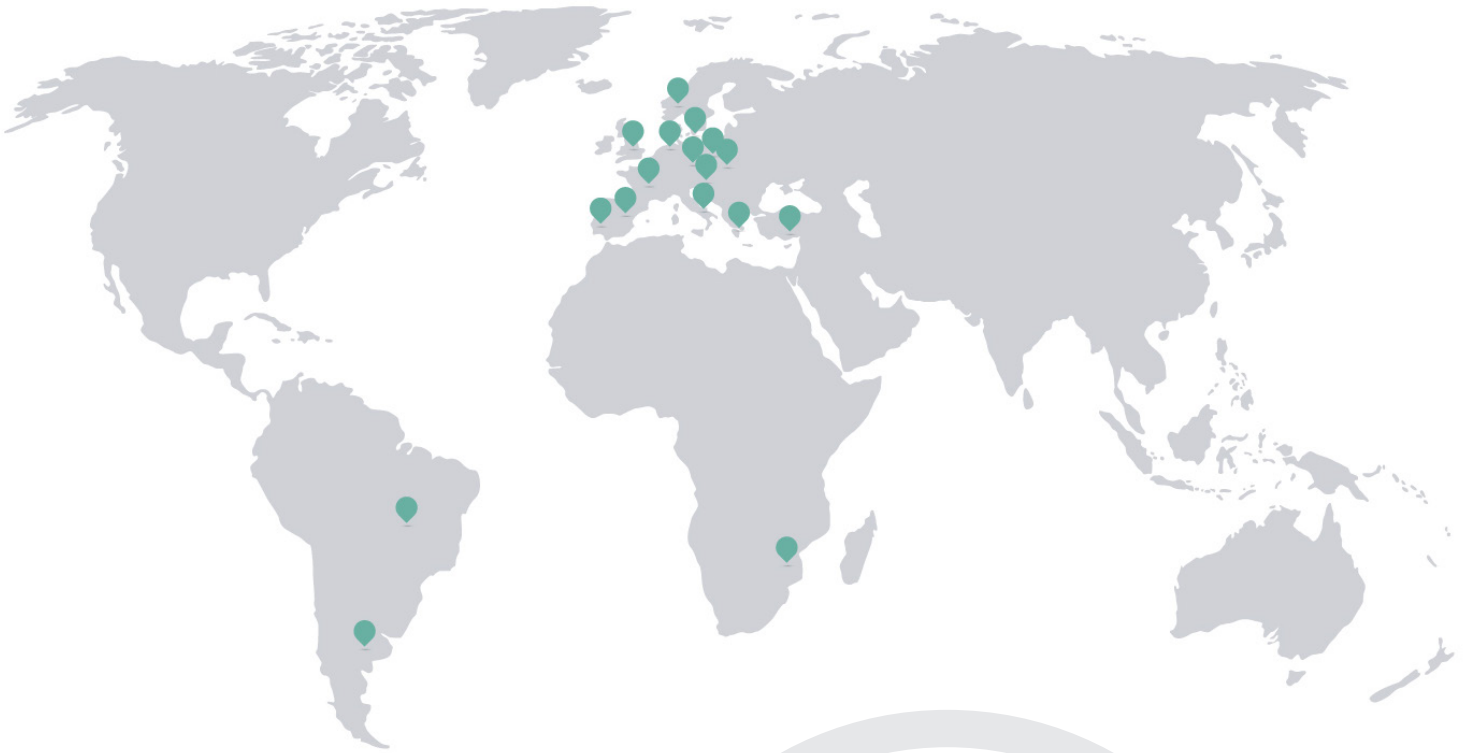

16 countries
+6 millions
doors openings

ARGENTINA
BRAZIL
CYPRUS
CROATIA

SLOVENIA
SPAIN
FRANCE
GREECE

ITALY
NETHERLANDS
HUNGARY
MOZAMBIQUE

NORWAY
POLAND
PORTUGAL
UNITED KINGDOM



Technical Support

Make the most of your access control.

homeit has at your disposal an in-house Technical Customer Support Team to help you get the most of our products and to solve any issues that you may encounter.

We have a specialised technical team who will be available to provide a fast and efficient response to all questions or difficulties raised to our Customers.



Partners

We are on your side, with a set off specialised and certified Partners (*), present in Portugal, Spain and also Italy.

Our Partners are available to support you in finding the best solution for your use-case and situation.

We believe that combination of our control access solutions and our provided Partner service are the

best recipe for success. That's why **homeit** Partners are specialists in sales, installation and after-sales support.

If you want to become a **homeit partner, please send an email to partners@homeit.io and join a solid brand that can help you complement your value- proposition and product offering to your customers.*



Our solutions

Remote access control



Remote access to your lock

homeit, is a leader in access control systems that offers an extensive smart locks range, wireless and wired, able to meet your business or home needs.

Have total control over the access to your door using a smartphone, PC or tablet. Create digital keys, send them to whom you have granted access to your property with all security and controlled way.

Control who enters and who's out, without traditional keys, and know exactly who is coming in, when and how they've entered (ej. APP or code), even when you're away. With a smart lock, you can easily open your door remotely, no matter where you are.

- Open the door remotely from anywhere.
- Receive notifications about your smart lock's activity.
- Control when and who has access to your home or business.
- Create personal codes to family, friends or household services which only allow entry on certain days and/or at certain times

Wherever you are, you can allow access to your home or business by remotely assigning temporary access, via personal digital codes, to those who need to get in.

homeit in VR

GENERAL SYSTEMS FEATURES



Easy access

homeit smart locks works through wireless, local or internet (in this case a **homeit BOX** is needed).



Easy management

Open the flat and street doors via **homeit** web APP®, SMS or keypad, with personal codes with expiry dates.



Easy installation

The entire installation is carried out inside the dwellings, without intervention need for the building's common areas.



Easy connect

The **homeit BOX** is installed next to the doors, with wireless connections to the smart lock and the internet access router. Optionally, it can be connected to the intercom to allow the opening of the street door.

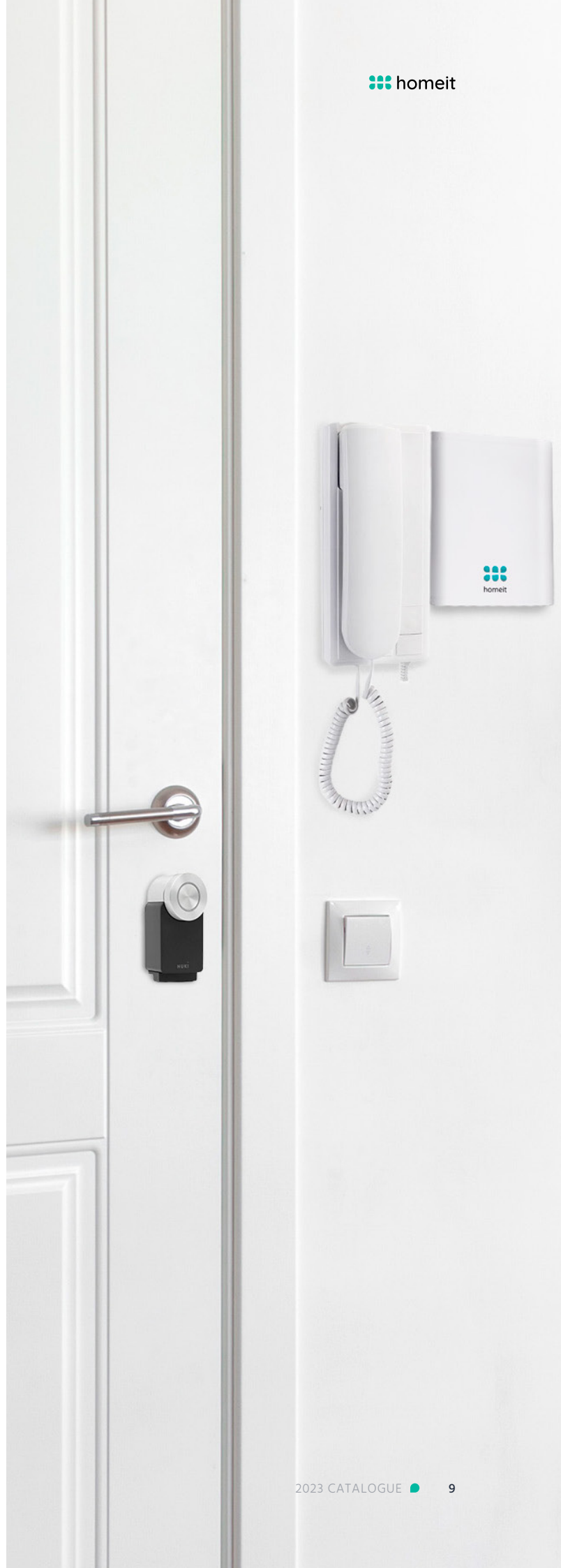



Standard features

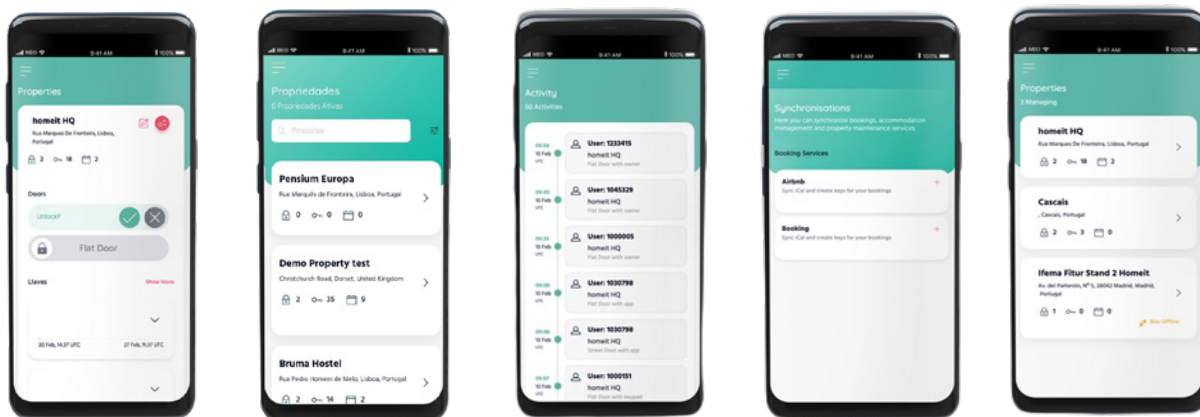

01

Manage access to one or more properties

03

Access codes full management

05

Open several door, include common access doors

02

Logging all entries and all users

04

Integrates with other applications (PMS)

Traditional locks general features



European Cylinder Lock

Can be use in a several types of locks – entrane doors or multi-lock. For security reasons, anti-panic cylinders can be used.



Mortise Lock

Rectangular shaft on which the handles are fixed. They are usually installed on interior doors.

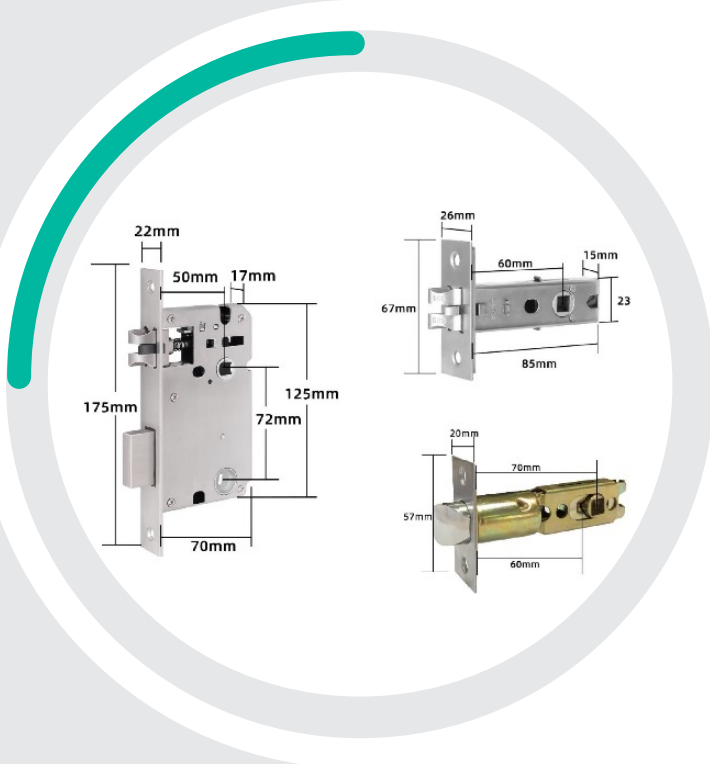



Market-tailored solutions

Business / Home





BUSINESS SOLUTIONS

Remote access control solutions, adapted to your business. Various remote and on-site smart locks opening methods, allowing total enterprise access control.

Access control solutions range able to answer your business requirements. Ideal for controlling, with security and flexibility, the entire enterprise access infrastructure.

Vacatinal Rental (VR)

SOLUTIONS FOR SPECIFIC USES

homeit guarantees you a 24-hour self check-in solution for any accommodation situation you may have: guesthouse, flat with common areas and adjacent buildings..

Advantages

- Property Management
- Manage and send digital keys - automatic sending with permissions between check-in and check-out
- Permanent Switches
- View openings
- Integration with Airbnk, Booking, Avantio, Google calendar, etc..
- Remotey openings
- Various locks models available for the overwhelming majority of cases.

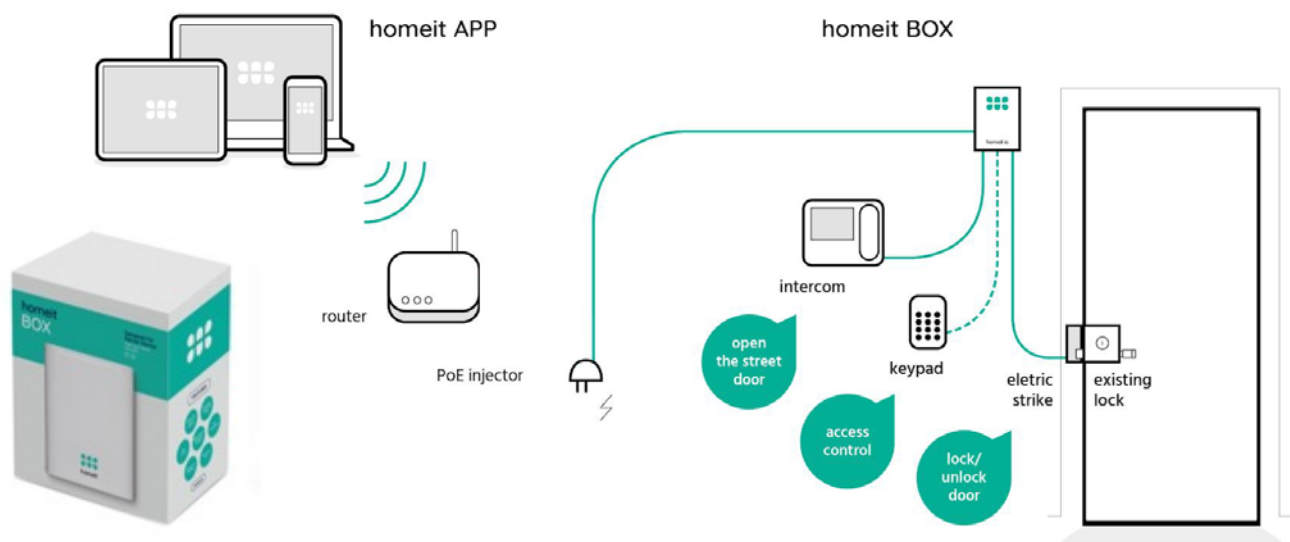
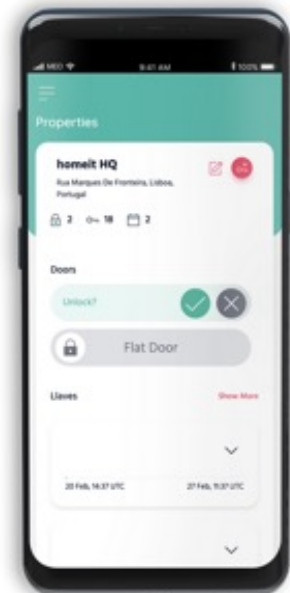
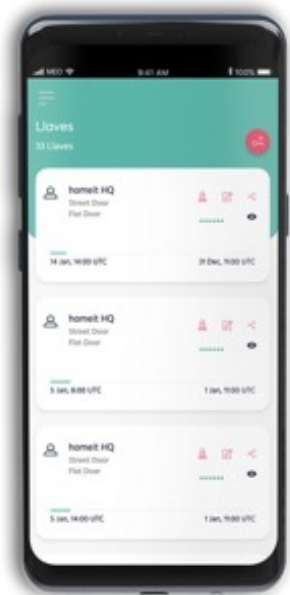

Hotels

SOLUTIONS FOR SPECIFIC USES

The **homeit** hotels solution is based on a Software platform with no upfront licensing costs, simple to configure and use. It interconnects a wide selection of

smart locks with smart room switches and also RFID cards.

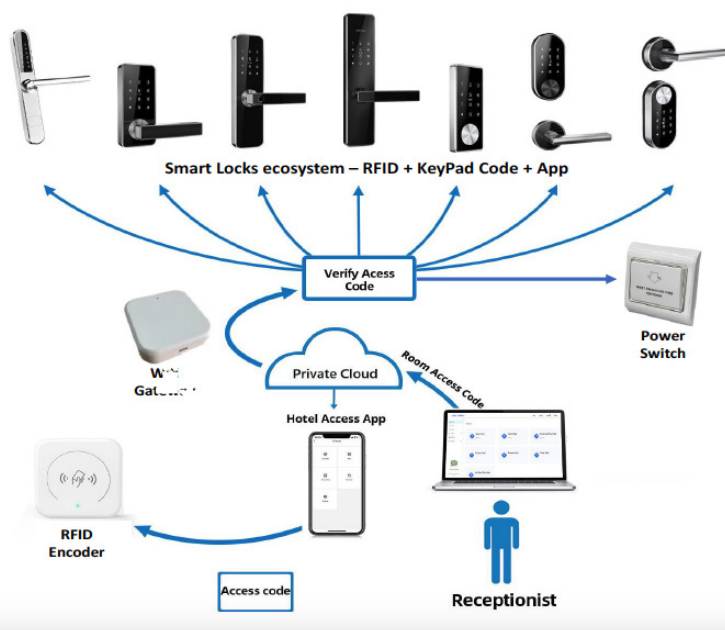
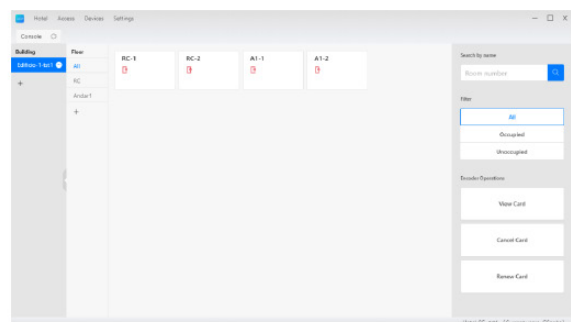

Advantages

- Various models of locks available
- RFID card programmer (Encoder)
- Power Saver (intelligent switch)
- SW Hotel (no up-front licensing costs)
- Check-In / Check-Out
- View openings
- Multiple Ways of Opening
 - Card
 - Numeric Code
 - Customer App
- Different Key Profiles
 - Customers
 - Staff (several types configuration)
- Booking room cleaning services

Self-Storage

SOLUTIONS FOR SPECIFIC USES

homeit solution is ideal for self-storage, allowing:

- Connect and control up to two doors with the same **homeit BOX**
- Connect several types of smart locks
- Use wireless keypads to enter access codes
- Low cost.

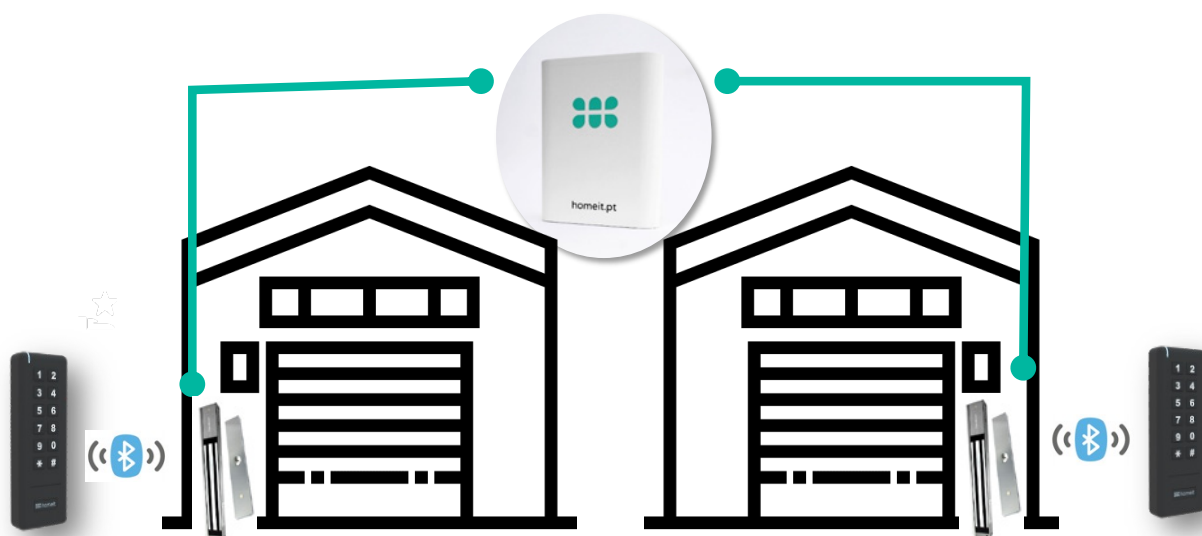

Advantages

- Access management to the different individual storerooms
- Send and manage digital keys - automatic sending with permissions between access start and end dates (contract duration)
- Opening views
- Remotely opening
- Various models of locks available for the overwhelming majority of cases.

Smart Lockers

SOLUTIONS FOR SPECIFIC USES

The **homeit** solution that transforms a traditional locker into a Smart Locker - No need to buy a new locker, which represents an immediate cost savings.

Our solutions have the flexibility you need to be installed on different doors types and drawers, but also in a different materials types.

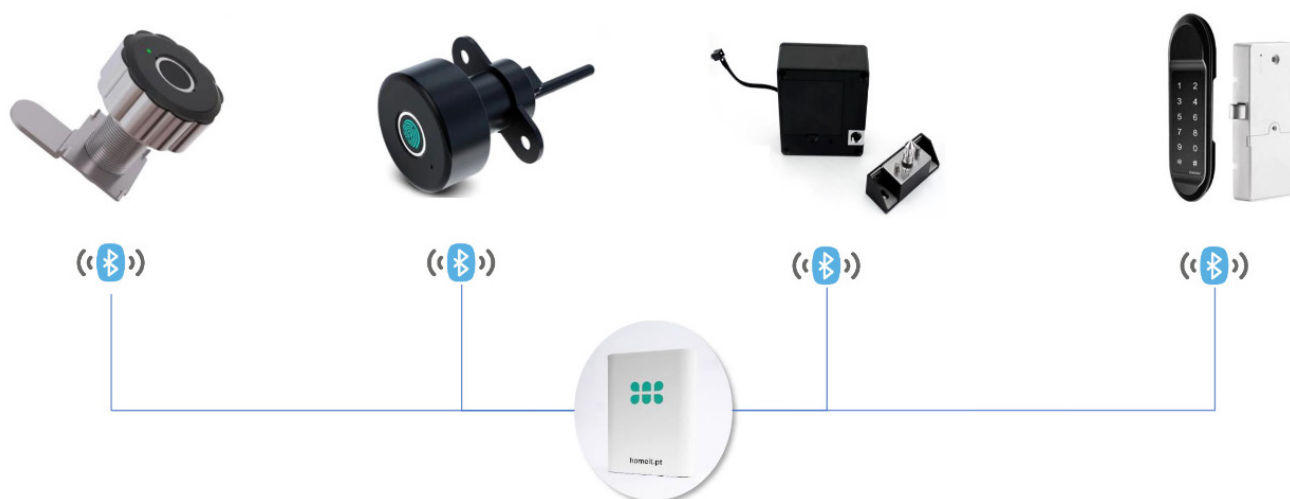

Advantages

- Property management
- Send and manage digital keys - automatic sending with access permissions between dates
- Optional permanent key creation
- Openings log display
- Remotely openings
- Fingerprint
- Open with RFID cards
- Optional integration with **homeit** system or stand-alone.

Glossary

LEARN ICONS MEANING.

The icons, present next to our products, allow a better understanding of the different product functionalities.

Whenever a single icon appears next to the product, it means that it can only be reconciled with the indicated software.

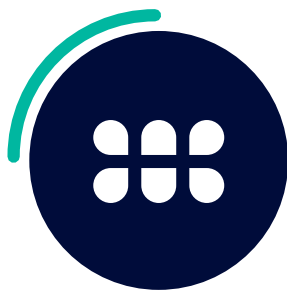

HOMEIT

Integrates with system **homeit**



TTLOCK

Software compatible
TTlock

Note: the acronym "N.A." means "Not Applicable"





Smart Locks

FOR EVERY USE CASE

Mortise Smart Locks

H11A

Small and compact lock suitable for installations with some vertical space restrictions. It has a built-in keypad.

Offers up to 4 modes of electronic and physical emergency key opening.

Includes a mechanical mortise lock.

H31A

Similar to the H11B, but larger in size, covering a larger installation area. Ideal for covering up old drill holes. It has a built-in keypad and a large front-panel.

Offers up to 4 modes of electronic and physical emergency key opening.

Includes a mechanical mortise lock.



ENE151

Lock indicated for hotel-type doors, with interior locking by push button. It has a built-in keypad.

Offers up to 4 modes of electronic and physical emergency key opening.

Includes a mechanical mortise lock.



S31A/B

Narrow body lock suitable for installations with limited space, with built-in keypad, suitable for doors in which the lock size is important.

Offers up to 4 modes of electronic and physical emergency key opening.

Includes a mechanical mortise lock.



N201

Lock indicated for interior doors, where the unlocking action is only on the latch.

It offers up to 4 electronic opening modes.

Includes Mortise mechanical lock.





H11B

MORTISE SMART LOCKS

Bluetooth smart lock access, controllable by smartphone. Allows openings through the app, numeric code, fingerprint, RFID cards and also through a physical emergency key. More than 10,000 openings can be expected under normal conditions.

Applicable to wooden and aluminium doors. Can be mounted on the left or on the right. Using the mechanical lock included with this model, it is possible to lock the door by simply turning the handle in the opposite direction. Automatically locks the door (auto-lock).

Excellent build quality.

Key features

| | |
|------------------------|-------------------------------|
| Lock type | Mortise |
| Feeding | Battery: 8xAAA (&V) |
| Material | Aluminium and plastic brushed |
| Available colors | Black, Silver |
| Thickness doors | 35-65mm 65-100mm |
| Opening option by RFID | Yes |

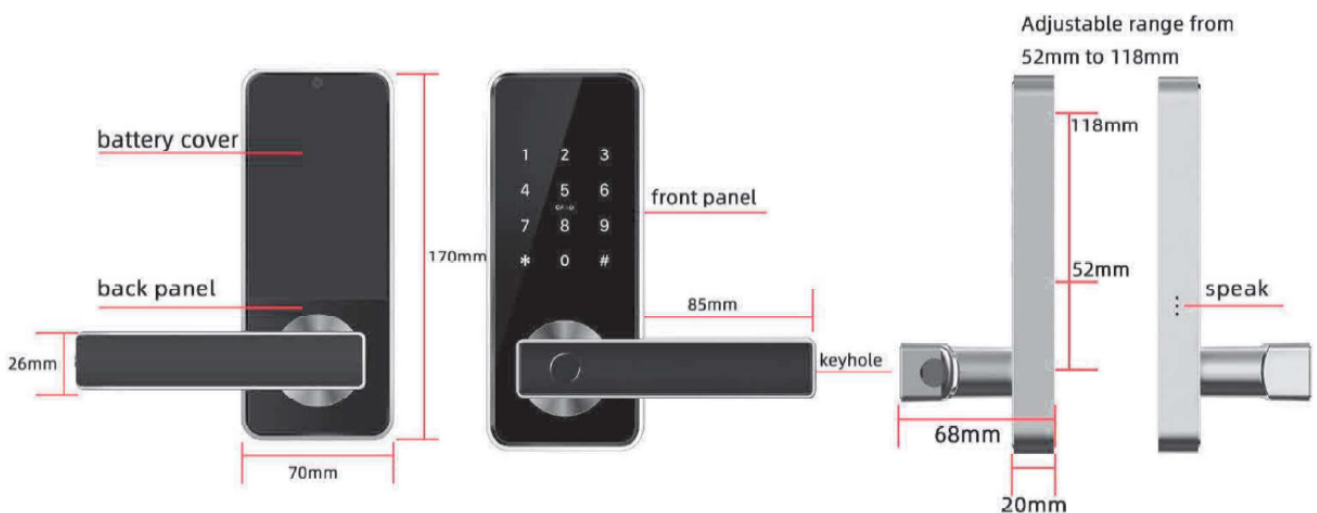



H31A

MORTISE SMART LOCKS

Bluetooth smart lock access, controllable by smartphone. Allows openings through the app, numeric code, fingerprint, RFID cards and also through a physical emergency key. More than 10,000 openings can be expected under normal conditions.

Applicable to wooden and aluminium doors. Can be mounted on the left or on the right. Using the mechanical lock included with this model, it is possible to lock the door by simply turning the handle in the opposite direction. Automatically locks the door (auto-lock).

It has a USB port to connecting an energy source (power bank for example) to open the door in case of depleted batteries. Excellent build quality.

Key features

| | |
|------------------|---------------------|
| Lock type | Mortise |
| Feeding | Battery: 8xAAA (&V) |
| Material | Aluminium & Plastic |
| Available colors | Black |
| Thickness doors | 35-65mm 65-100mm |
| RFID option | Yes |

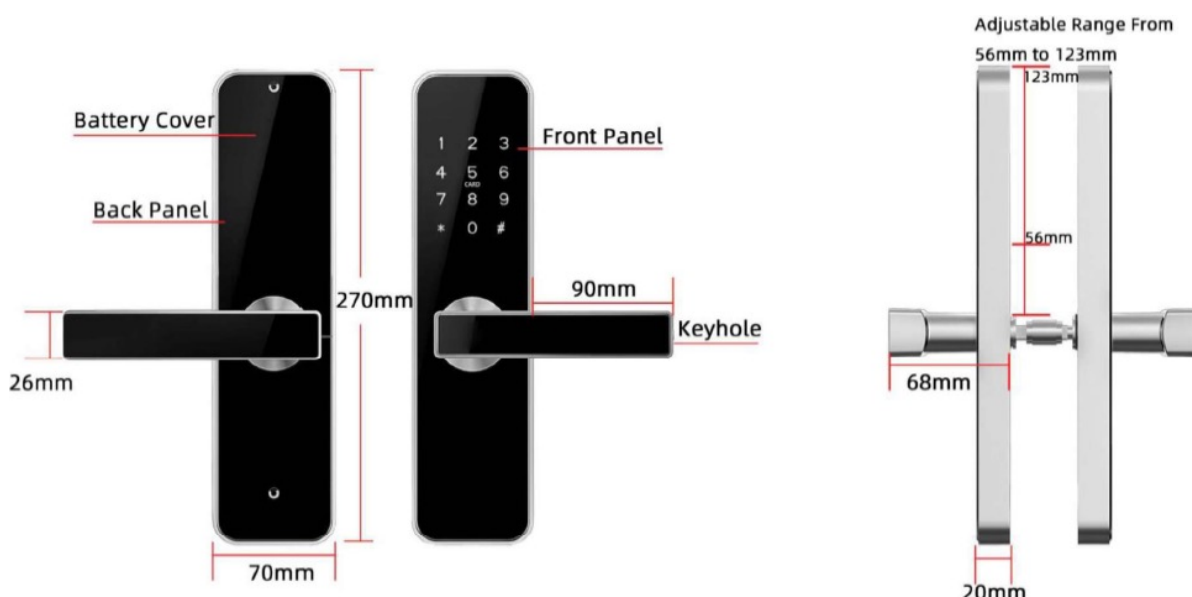

ENE151

MORTISE SMART LOCKS

Bluetooth smart lock access, controllable by smartphone. Allows openings through the app, numeric code, fingerprint, RFID cards and also through a physical emergency key. More than 10,000 openings can be expected under normal conditions.

It has a USB port to connecting an energy source (power bank for example) to open the door in case of depleted batteries.

Applicable to wooden and aluminium doors. Can be mounted on the left or on the right side. Automatically locks the door (auto-lock).

Ideal for doors hotel type, in which you need to lock the door from the inside through a simple button. Excellent build quality.



Key features

| | |
|-------------------|----------------|
| Lock type | Mortise |
| feeding | Battery: 4xAAA |
| Material | Aluminium |
| Available colours | Black, Silver |
| Thickness doors | 35-55mm |
| RFIP Option | Yes |

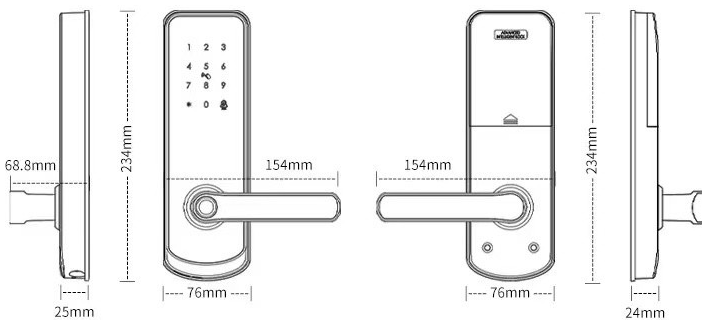

S31

MORTISE SMART LOCKS

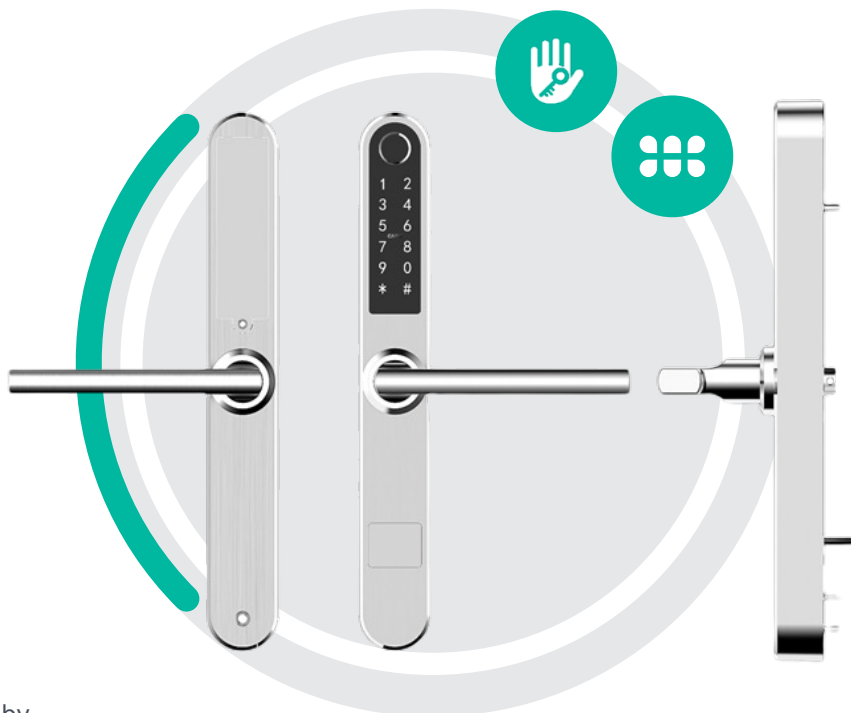

Bluetooth smart lock access, controllable by smartphone. Allows openings through the app, numeric code, fingerprint, RFID cards and even through a physical emergency key. Allows more than 15,000 openings in normal conditions.

Applicable to wooden and aluminium doors. Can be mounted on the left or on the right. Using the mechanical lock included with this model, it allows locked the door by simply turning the handle in the opposite direction. Various mortise lock models available. Automatically inhibits the opening of the door (auto-lock).

Excellent build quality.

Key features

| | |
|-------------------|-----------------------------|
| Lock type | Mortise |
| Feeding | Battery: 4xAAA |
| Material | Aluminium |
| Available colours | Grey, Golden, Black, Silver |
| Thickness doors | 55-115mm |
| RFID Option | Yes |

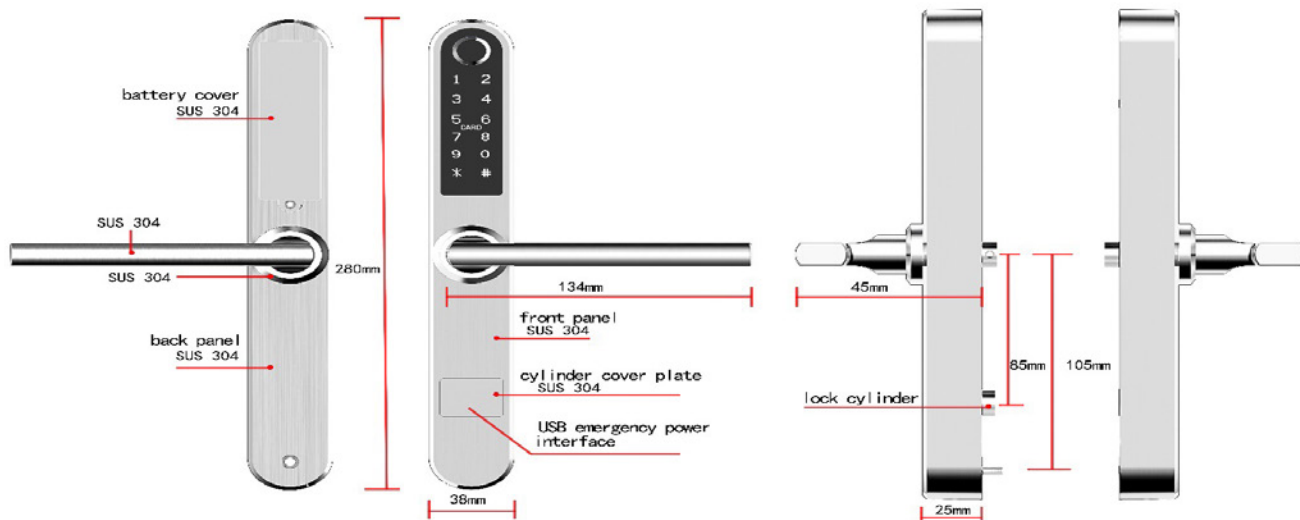



N201

MORTISE SMART LOCKS

Smart lock with Bluetooth access, controllable via mobile phone. Allows openings through the App, numeric code, fingerprint, RFID cards and also through physical emergency key. It allows to make more than 10,000 openings under normal conditions.

It has a USB port for connecting a power source (powerbank p.e.) to open the port in case of exhausted batteries .

Applicable to wooden and aluminum doors. Possibility of mounting to the left or right. Automatically locks the door (auto-lock).

Ideal for Hotel type doors, where you want to lock the door from the inside, through a simple button. Excellent construction quality.

| Key features | |
|-------------------|----------------|
| Lock type | Mortise |
| Alimentação | Battery: 4xAAA |
| Material | Aluminium |
| Available colours | Black |
| Thickness doors | 35-55mm |
| RFID Option | Yes |

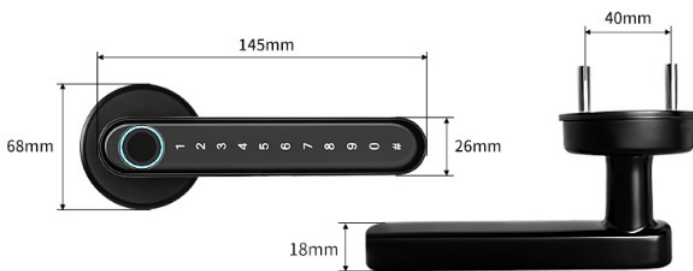

Smart Locks Adaptable to Existing Lock

● NUKI 3.0

High-end motorised lock that is mounted on top of the existing lock with a simple installation. It completely locks the door with full turns. Perfectly complements the **homeit BOX** (see detailed description in later section).



● NUKI 3.0 PRO

High-end motorized lock to adapt to your current lock without having to change anything – it turns your lock key.

Compatible with all Nuki accessories and the **homeit BOX**. With wifi and available in white and black colors



Smart Cylinder

SMART LOCK WITH EUROPEAN CYLINDER

Smart cylinder with Bluetooth access, controllable by smartphone. Allows opening through app, numerical code, RFID cards and also through a physical emergency key. It is expected to open more than 10,000 doors in normal conditions of use.

Applicable to wooden and aluminium doors, reusing the existing lock. Several models are available with different dimensions, depending on the size of your existing cylinder.

Incorporated keypad. Easy to install. Low maintenance requirements. Excellent build quality.



Key features

| | |
|-------------------|----------------------|
| Feeding | Battery: 4xAAA |
| Material | Aluminium & Plastic |
| Available colours | Grey |
| Thickness doors | Several combinations |
| RFID Option | Yes |





homeit BOX + NUKI 3.0

STARTER KIT

Kit with Nuki lock and **homeit BOX** for use with homeit system.

Ideal for vacations rentals offices, gyms, etc...

Has the advantage of not having to change the existing lock on the door. Easy to install.

homeit BOX + Smart Cylinder

STARTER KIT

Kit with Smart Cylinder and **homeit BOX** for use with the **homeit**.

Ideal for vacations rental, offices, gyms, etc...

Easy to install. Maintains your current lock.



homeit BOX + NUKI 3.0

STARTER KIT

Kit with Nuki lock and **homeit BOX** for use with homeit system.

Ideal for access points that require high security in offices or short-term rentals.

Offers the advantage of not needing to change the existing door lock.

Easy to install.

Automatically locks with each turn within a set time frame using the auto-lock feature.

Does not include a Mortise mechanical lock.



Kit with smart lock NUKI (motorized) to attach to existing lock, with Bluetooth access, controllable via smartphone. Easy to install and configure. It opens by turning the key in a existing lock.

homeit system allows online access to:

- Property management
- Manage/Create and sent digital keys between check-in and check-out dates
- Create permanent keys
- Remotely openings
- Viewing entry logs

Also allows integration with Airbnb, Booking, Avantio, Google calendar, etc.

Key features

| | |
|------------------|---------------------|
| Key type | N.A. |
| Feeding | Battery: 4xAAA |
| Material | Aluminium & Plastic |
| Available colour | Grey & Black |
| Thickness doors | No |
| RFID Option | No |





homeit BOX + Smart Cylinder

STARTER KIT

Kit with Smart Cylinder and **homeit BOX** for use with the homeit system.

Ideal for vacations rental, offices, gyms, etc...

Easy to install. Maintains your current lock. Kit with Smart Cylinder and **homeit BOX** that allows the reuse of existing lock. Locks automatically at all lock points. Simple and quick DIY (Do it Yourself) installation. Great battery autonomy longevity of 1 year.

homeit system allows online access to:

- Property management
- Manage/Create and sent digital keys between check-in and check-out dates
- Create permanent keys
- Remotely openings
- Viewing entry logs

Integrations with Airbnb, Booking, Avantio and Google calendar are also possible.

Key features

| | |
|------------------|------------------------------|
| Lock type | European Cylinder |
| Feeding | Battery: 4xAAA |
| Material | Aluminium & Plastic |
| Available colour | Grey |
| Thickness doors | Several dimensions available |
| RFID Option | No |





E15

LOCKS FOR GLASS DOORS

Smart lock for glass doors.

It has the advantage of not needing to drill holes in the door and being easy to install.

It offers up to 4 electronic opening modes and an emergency physical key.

The E15 is a smart lock specially made for easy installation in glass doors. It can be installed directly on the glass, without drilling and in a quick and simple way.

Allows openings through app, numeric code, fingerprint, RFID cards and also through a physical emergency key.

It is expected to make more than 10.000 openings, under normal use conditions.

Ideal for offices, shops, schools and laboratories.

Key features

| | |
|-------------------|------------------|
| Feeding | Battery: 4xAA |
| Material | Zinc & Aluminium |
| Available colours | Black |
| Thickness doors | 10-15mm |
| RFID Option | Yes |



Electric Locks with homeit BOX installation

Motorized Lock

Surface mounted lock, suitable for installing on wooden doors without a mortice lock.

Electrically powered from the physical connection to the **homeit BOX**.



Electric Strike

Built-in electric strike Installation inside the door frame.

Ideal for wooden or metal doors.

Electrically powered from the physical connection to the **homeit BOX**.



Electric Locks with homeit BOX installation

EVA

Recommended for refurbishing and where security is a concern. It fully locks automatically. It is wired from the door frame for an easier installation with the homeit BOX.



Magnetic Lock

Highly durable and reliable electromagnetic lock.

Discreet installation in the door frame. Power supply by cable through the homeit BOX.





Motorized Lock

ELECTRIC LOCKS WITH HOMEIT BOX INSTALLATION

This surface-mounted Motorized Lock is better installed in wooden doors where you can install its rim cylinder. It is electrically powered from the physical connection to **homeit BOX**. Locks automatically when the door closes due to included magnetic sensor. Allows opening through app, code on the keypad and physical key, in case of need.

homeit system allows online access to:

- Property management
- Manage/Create and sent digital keys between check-in and check-out dates
- Create permanent keys
- Remotely openings
- Viewing entry logs

Also allows integration with Airbnb, Booking, Avantio, Google calendar, etc.

Key features

| | |
|-------------------|---------------------|
| Feeding | Electric/wire – 12V |
| Material | Aluminium |
| Available colours | Grey |
| Thickness doors | N.A. |
| RFID Option | No |



OPTIONAL:
BLUETOOTH
KEYPAD
HOMEIT



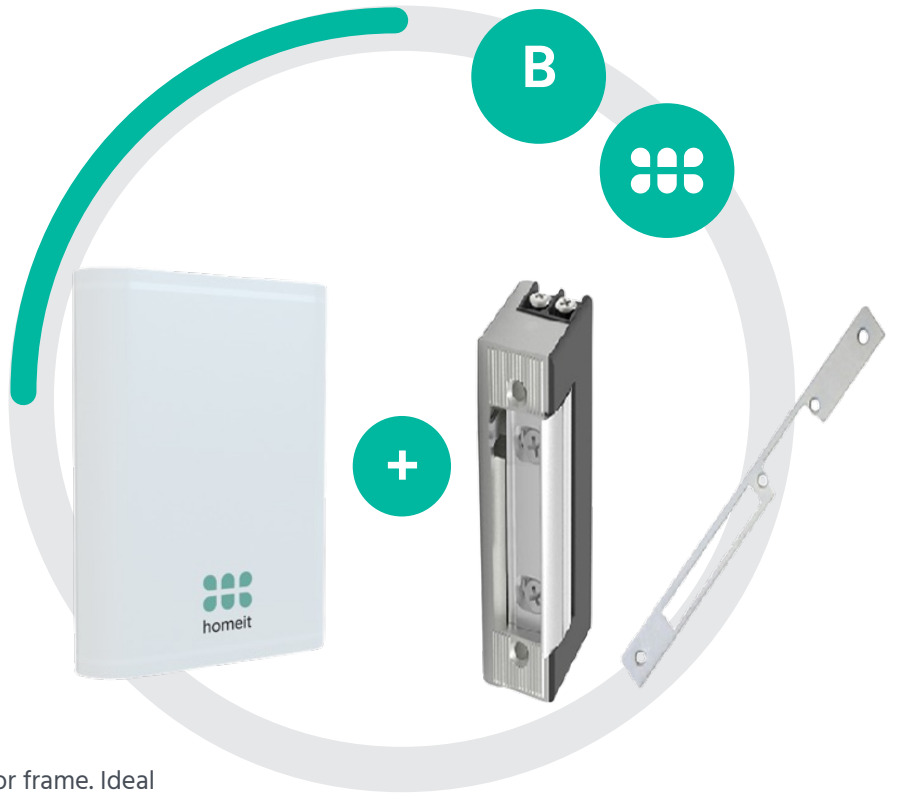

Electric Strikes

ELECTRIC LOCKS WITH HOMEIT BOX INSTALLATION

Electric strikes are installed inside the door frame. Ideal for wooden or metal doors. Electrically powered from the physical connection to **homeit BOX**. Opens the door by acting on the existing lock.

homeit system allows online access to:

- Property management
- Manage/Create and sent digital keys between check-in and check-out dates
- Create permanent keys
- Remotely openings
- Viewing entry logs

Also allows integration with Airbnb, Booking, Avantis, Google calendar, etc.

| Key features | |
|-------------------|-----------|
| Feeding | Electric |
| Material | Aluminium |
| Available colours | Silver |
| Thickness doors | N.A. |
| RFID Option | No |

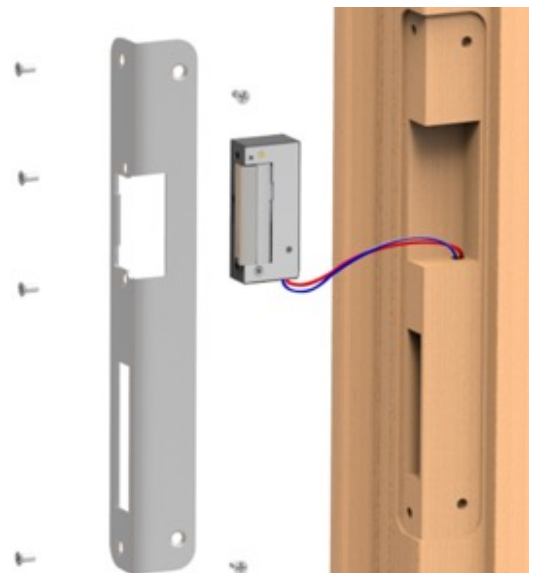

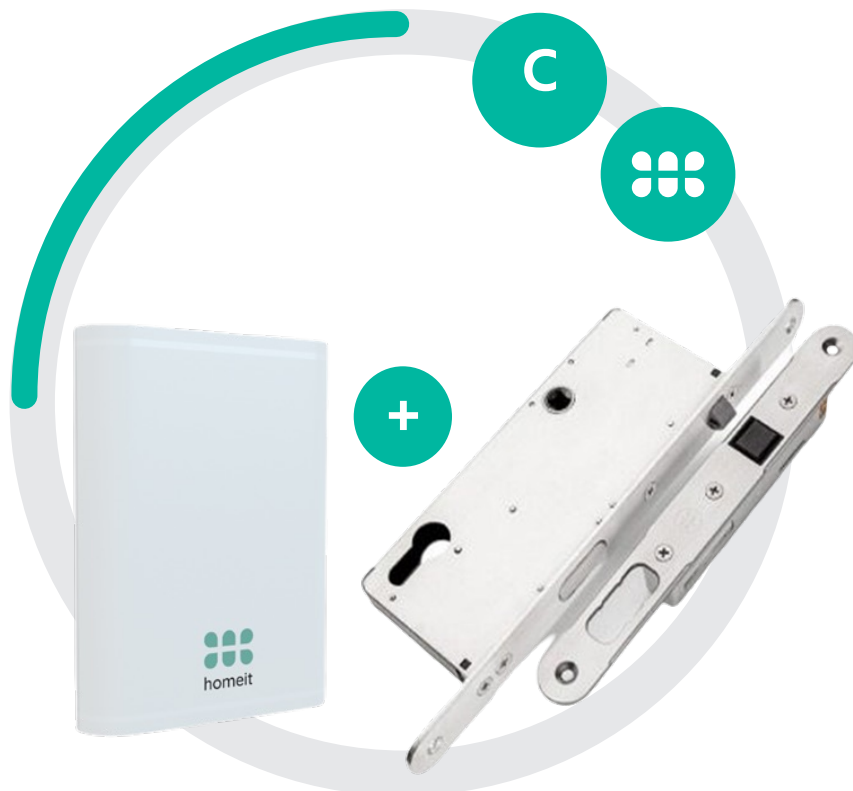

Eva Lock

ELECTRIC LOCKS WITH HOMEIT BOX INSTALLATION

The EVA lock is an electromechanical security lock that fully locks in one point and is wired by the **homeit BOX** in the frame of the door. The best solution in terms of security, aesthetics, and maintenance (battery-free). Automatically locks in 1 point. Compatible with doors up to 100kg and ideal for remodeling or new construction projects. Also available is a version with 3 locking points. A favorite among architects.

homeit system allows online access to:

- Property management
- Management/generation and sending of digital access keys between check-in and check-out dates
- Creation of permanent keys

- Execute remote openings
- Viewing entry logs

Also allows integration with Airbnb, Booking, Avantio, Google calendar, etc.

Key feature

| | |
|-------------------|---------------------|
| Feeding | Electric/wire – 12V |
| Material | Aluminium |
| Available colours | Silver |
| Thickness doors | N.A. |
| RFID Option | No |



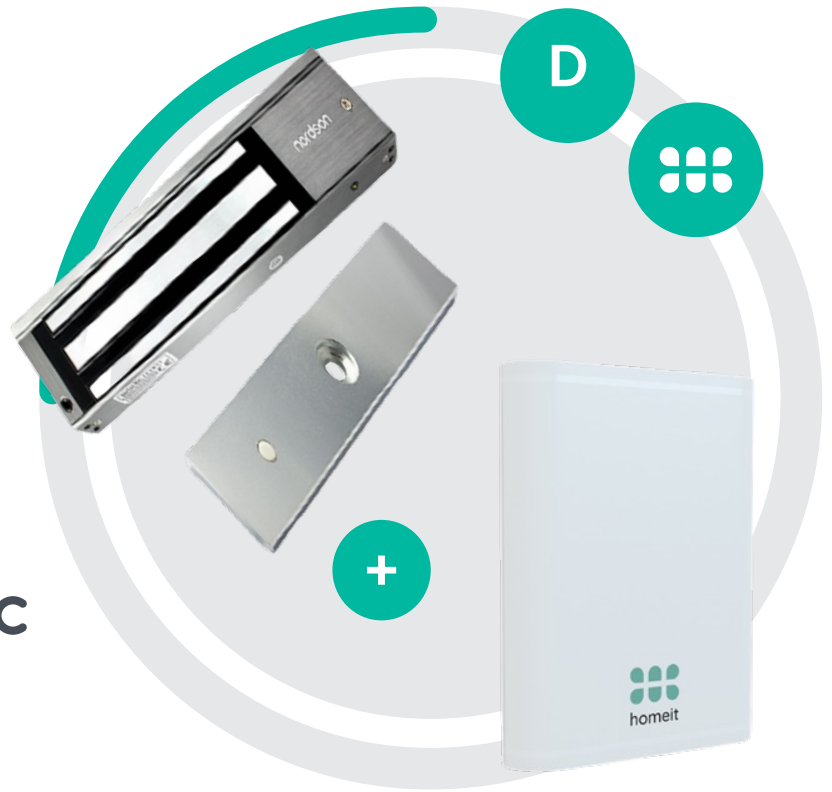

Electromagnetic Lock

ELECTRIC LOCKS WITH HOMEIT BOX INSTALLATION

Highly durable and reliable electromagnetic lock. Discreet installation in the door frame. Power supply by cable through the **homeit BOX**. No batteries are needed. Perfect for doors with intensive use. Automatically locks the door. Solution compatible with all types of doors. Multiple models available with holding force ranging from 500 kg to 1500 kg.

homeit system allows online access to:

- Property management
- Manage/create and send digital access keys between check-in and check-out dates
- Create permanent keys

- Remotely openings
- Viewing entry logs

Also allows integration with Airbnb, Booking, Avantio, Google calendar, etc.

Key features

| | |
|-------------------|---------------------|
| Feeding | Electric/wire – 12V |
| Material | Aluminium |
| Available colours | Silver |
| Thickness doors | N.A. |
| RFID Option | No |



Keypad

homeit PAD

homeit wireless indoor keypad for solutions with homeit BOX.

Complements several homeit solutions.

Great autonomy.



Outdoor wired keypad

Wired outdoor keypad for solutions with homeit BOX.

Complements various homeit solutions. Includes a rear case for IP65 protection. (rain and dust)



K2

Indoor/outdoor keypad, with physical connection to a lock or electric lock and Bluetooth connection to homeit BOX, allowing great installation flexibility.

IP66 protection grade.

It can control a second electric lock.

It includes opening mode with RFID cards.





homeit PAD

KEYPAD

The **homeit** keypad is easy to install and connects to the **homeit BOX** via Bluetooth for access to the property in question by entering a code, without the need for an app.

It has the great advantage of being able to complement any solution implemented with the **homeit BOX**.

Examples of use:

- Self Storage: **homeit BOX** + Electric Strike + homeit PAD
- Short-rental Apartment : **homeit BOX** + Nuki + homeit PAD

Key features

| | |
|-------------------|---------|
| Feeding | 3xAAA |
| Material | Plastic |
| Available colours | Black |
| Thickness doors | N.A. |
| RFID Option | No |

Outdoor Keypad

KEYPAD



Outdoor keypad with physical connection to the **homeit BOX**, to access the property without the need to use the APP.

It has the great advantage of being able to complement any solution implemented with the **homeit**.

Examples of use:

- Main entrance buildings: **homeit BOX** + existing electric lock + Outdoor Keypad
- Apartment facing the street: **homeit BOX** + Nuki Smartlock + Outdoor Keypad

Suitable for entrance doors of buildings or exterior common doors.

Key features

| | |
|-------------------|---------------------------------------|
| Feeding | Connection to homeit BOX with 7 wires |
| Material | Aluminium & Plastic |
| Available colours | Black |
| Thickness doors | 55-115mm |
| RFID Option | No |

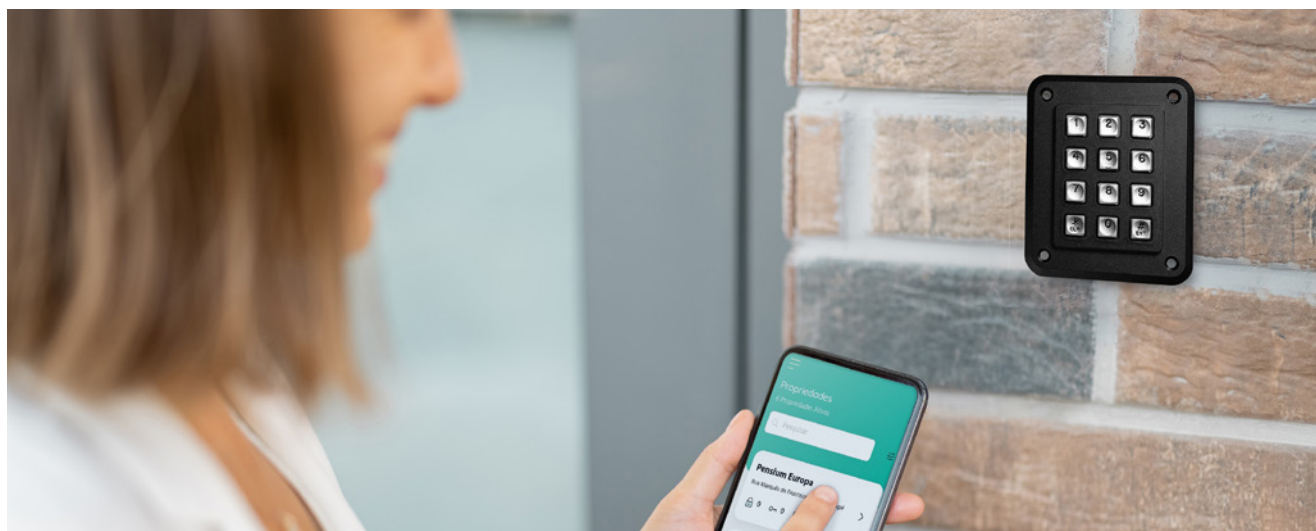



K2

KEYPAD

IP66 outdoor keypad, with Bluetooth access to manage door access opening using a smartphone. It controls electric gates, electromagnetic locks and EVA locks.

It allows openings through app, numeric code, fingerprint and RFID cards.

It allows the incorporation of an instant opening button as well as a signal buzzer.

Ideal for solutions with no batteries.

Key features

| | |
|-------------------|---------------|
| Feeding | Cable - 12V |
| Material | Aluminium |
| Available colours | Black, Silver |
| Thickness doors | N.A. |
| RFID Option | Yes |

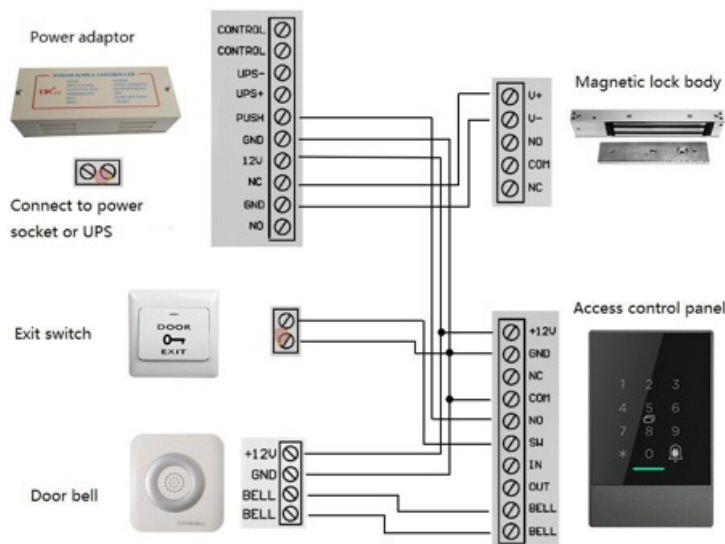

Locks for lockers and drawers

IB912B

Interior lock for lockers with keypad.

Allows three types of opening.



ENE57

Interior lock for drawers and/or lockers.

Designed for wooden drawers.

It allows two types of openings.



ENE203

Motorized interior lock for lockers.

Ideal for wooden or plate doors.

It offers 2 electronic opening modes.

It is characterized by its small dimensions.



ENE201

Interior lock for drawers and/or lockers.

It offers 2 electronic opening modes.

It is characterized by its small dimensions.



IKB1A

Safe for physical key storage, with numeric keypad.

Allows three types of opening.



IKB1A

Safe for physical key storage, with numeric keypad.

Allows three types of opening.





IB912B

LOCKS FOR LOCKERS AND DRAWERS

Smart lock with Bluetooth access, controllable via mobile phone.

Allows openings through the application, numeric code, RFID cards.

It is expected to make more than 10,000 openings, under normal conditions of use.

Designed for lockers with wooden doors. Very easy to install.

Key features

| | |
|-------------------|---------------------|
| Feeding | 3xC123A |
| Material | Aluminium y Plastic |
| Available colours | Grey and Black |
| Thickness doors | N.A. |
| RFID Option | Yes |

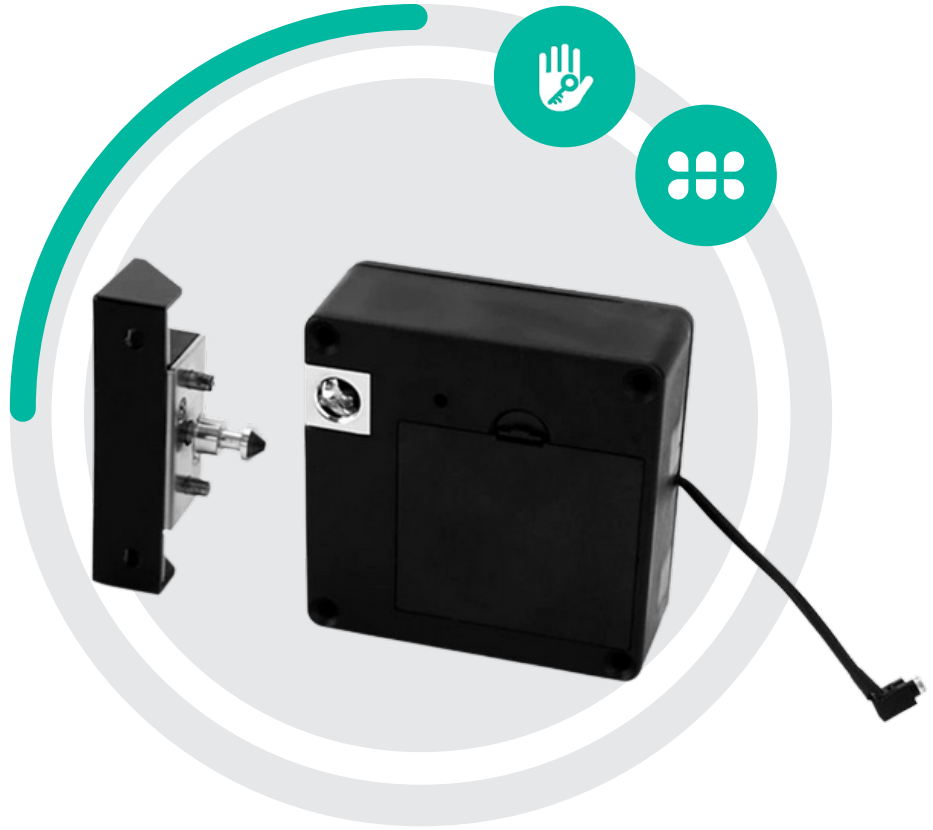

ENE57

LOCKS FOR LOCKERS AND DRAWERS

Smart lock for locker, small size and with Bluetooth access, controllable by smartphone. Allows openings through app, RFID cards and also through a physical emergency key.

It is expected to open more than 10.000 doors in normal conditions of use.

Suitable for drawers or wooden doors, but can be used in other materials.

It can be installed vertically or horizontally.

Key features

| | |
|-------------------|--|
| Feeding | Battery 4x AA; external feeding option |
| Material | ABS flame retardant plastic. |
| Available colours | Grey |
| Thickness doors | Until 50mm |
| RFID Option | Yes |





ENE203

LOCKS FOR LOCKERS AND DRAWERS

Mini smart cylinder, motorized and with Bluetooth access, for lockers and drawer modules, controllable by smartphone. Allows the opening through app or fingerprint.

It has a mini-usb port for emergency charging.

Applicable to both wooden and aluminium doors, reusing your existing locker.

Very easy to install.

Key features

| | |
|-------------------|------------|
| Feeding | 3xC123A |
| Material | Zinc Alloy |
| Available colours | Silver |
| Thickness doors | N.A. |
| RFID Option | No |

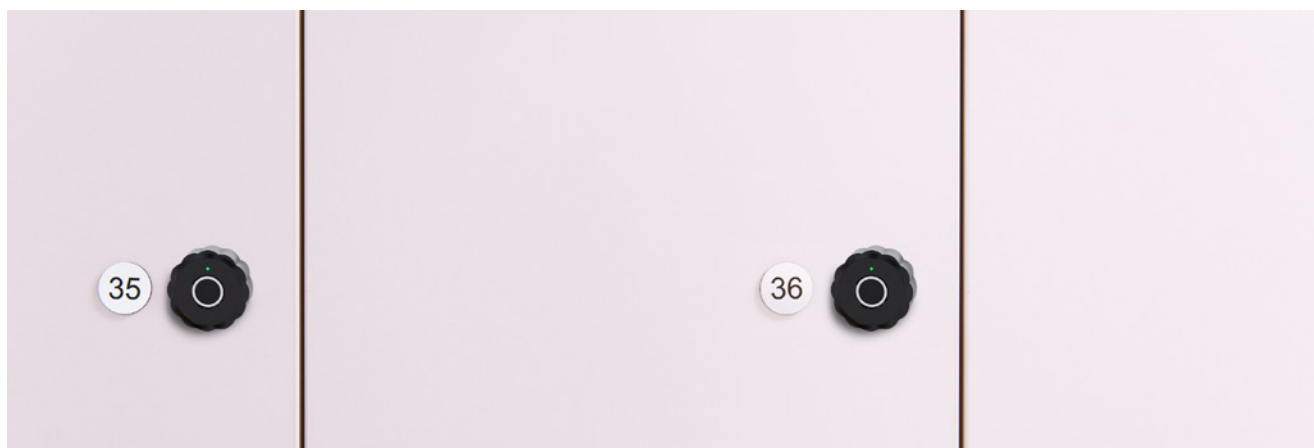



ENE201

LOCKS FOR LOCKERS AND DRAWERS

Smart mini-cylinder for lockers, with access, controllable by smartphone.

Allows manual opening, through app or fingerprint.

Applicable to both wooden and aluminium doors, reusing your existing locker.

Very easy to install.

Key features

| | |
|-------------------|---------------------|
| Feeding | 3xC123A |
| Material | Aluminium & Plastic |
| Available colours | Black |
| Thickness doors | N.A. |
| RFID Option | No |

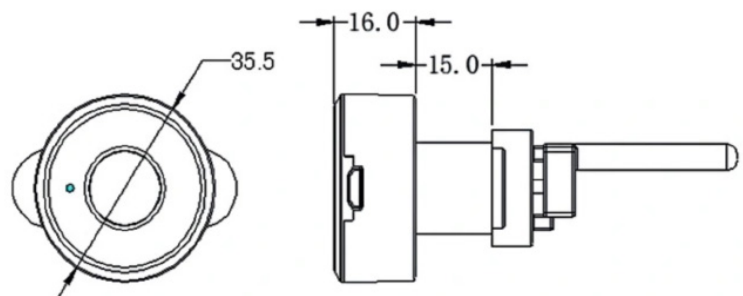

Unit: mm



IKB1A

LOCKS FOR LOCKERS AND DRAWERS

Smart mini safe for key storage, with controllable access via mobile phone.

Allows manual opening, through the application or fingerprint.

Fixing on exterior or interior surfaces or removable installation..

Very easy to install.

Key features

| | |
|-------------------|---------------------|
| Feeding | 3xC123A |
| Material | Aluminium & Plastic |
| Available colours | Black |
| Thickness doors | N.A. |
| RFID Option | No |





HOME SOLUTIONS

Local or remote access control solutions for your home doors. Smart locks with simplified entries management by using a smartphone, via homeit app **homeit**.



Smart Cylinder

HOME SOLUTIONS

Non-motorized lock for doors with a European cylinder.

It offers three opening modes: manual opening if opened from the inside, key opening if opened from the outside, and app or code-based opening..

Smart cylinder with Bluetooth access, controllable by smartphone. Allows opening through the app, numerical code, RFID cards and also through a physical emergency key. It is expected to open more than 10,000 doors in normal conditions of use.

Applicable to wooden and aluminium doors, reusing the existing lock. Various models are available depending on the size of the door. Easy to install. Incorporated keypad.

Low maintenance requirements. Excellent build quality.

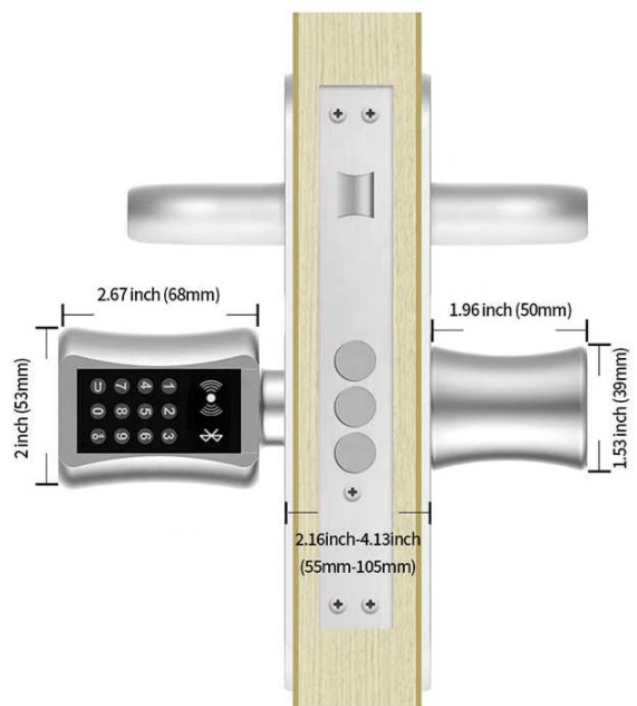

Key features

| | |
|-------------------|-----------------------|
| Feeding | 4x AA (6V) |
| Material | Aluminium & Plastic |
| Available colours | Grey |
| Thickness doors | View details cylinder |
| RFID Option | Yes |



NUKI 3.0 PRO

HOME SOLUTIONS

High-end motorized lock for adaptation to your existing lock without having to change anything - rotates the key of your lock.

Compatible with all Nuki accessories and with the **homeit BOX**. With integrated Wi-Fi and available in white and black colors.



WWW.HOMEIT.IO



Rua Maria Pimentel
Montenegro, 5B
1500 - 440 Lisboa



+351 937 590 442



sales@homeit.io